

(Following Paper ID and Roll No. to be filled in your  
Answer Books)

Paper ID : 181209

Roll No.

--	--	--	--	--	--	--	--	--	--

**B. Arch.**

**Theory Examination (Semester-II) 2015-16**

**ARCHITECTURAL DRAWING-II**

**Time : 3 Hours**

**Max. Marks : 100**

**Note : 1. Attempt all sections.**

**2. Marks are written against each Question.**

**Section-A**

**Q1. (a) Write the short cut keys for the following commands:**  
(10)

- a. Multiline
- b. Hatch Edit
- c. Write Block
- d. Copy
- e. Chamfer

- (b) OSNAP is used for- (2)
- (c) Why we give the limits before start drafting the any drawing in autocad- (2)
- (d) Give the command to rotate an object- (2)
- (e) Give the command for undoes the last operation- (2)
- (f) Give the difference between L and XL commands in auto-cad- (2)

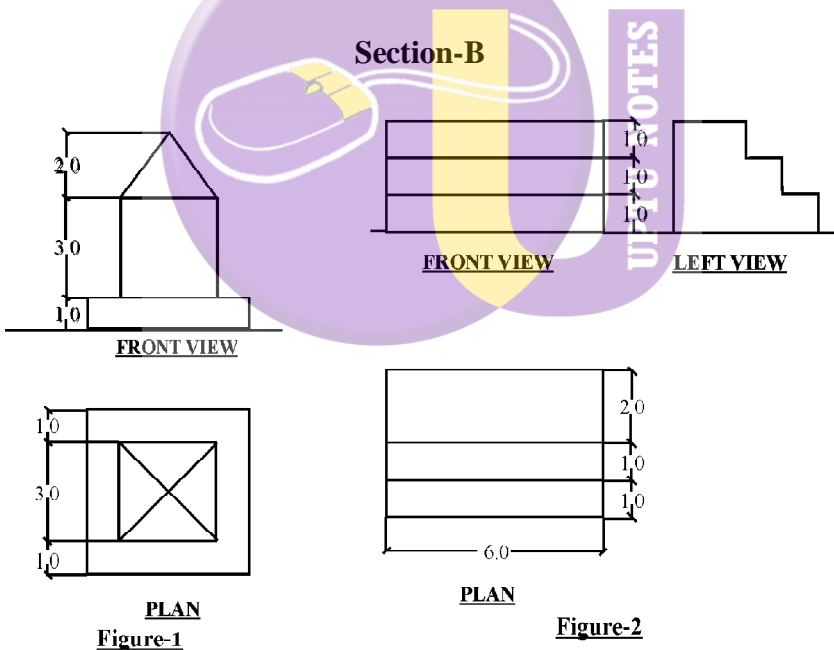

(2)

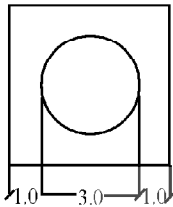
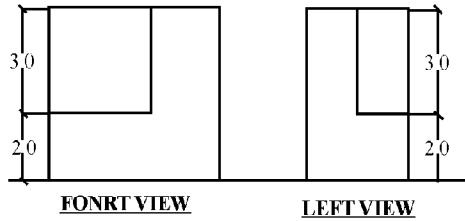
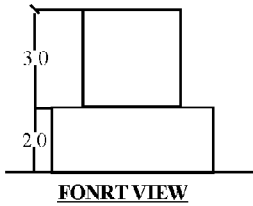

**Figure-3**

**Figure-4**

**Question 2 is compulsory. Attempt question 3 or 4. (50)**

Q2. Draw Isometric of the any three of the above figures. (30)

Q3. Draw One point perspective of figure 1 and figure 2. (20)

Q4. Draw Two point perspective figure 1 and figure 2. (20)

### Section-C

Q5. Draw one point or two perspective of the Figure 5. (30)

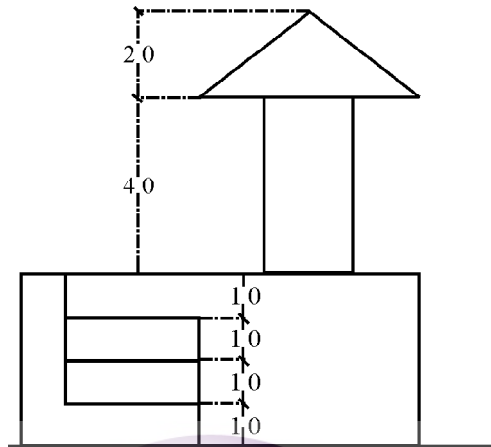

**FRONT VIEW**

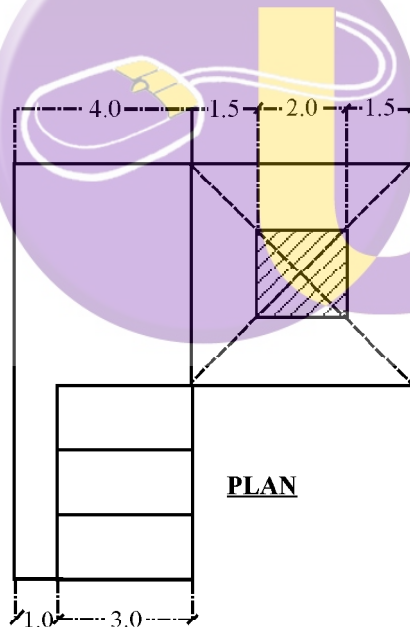

**PLAN**

UPTU NOTES

**Figure 5**